

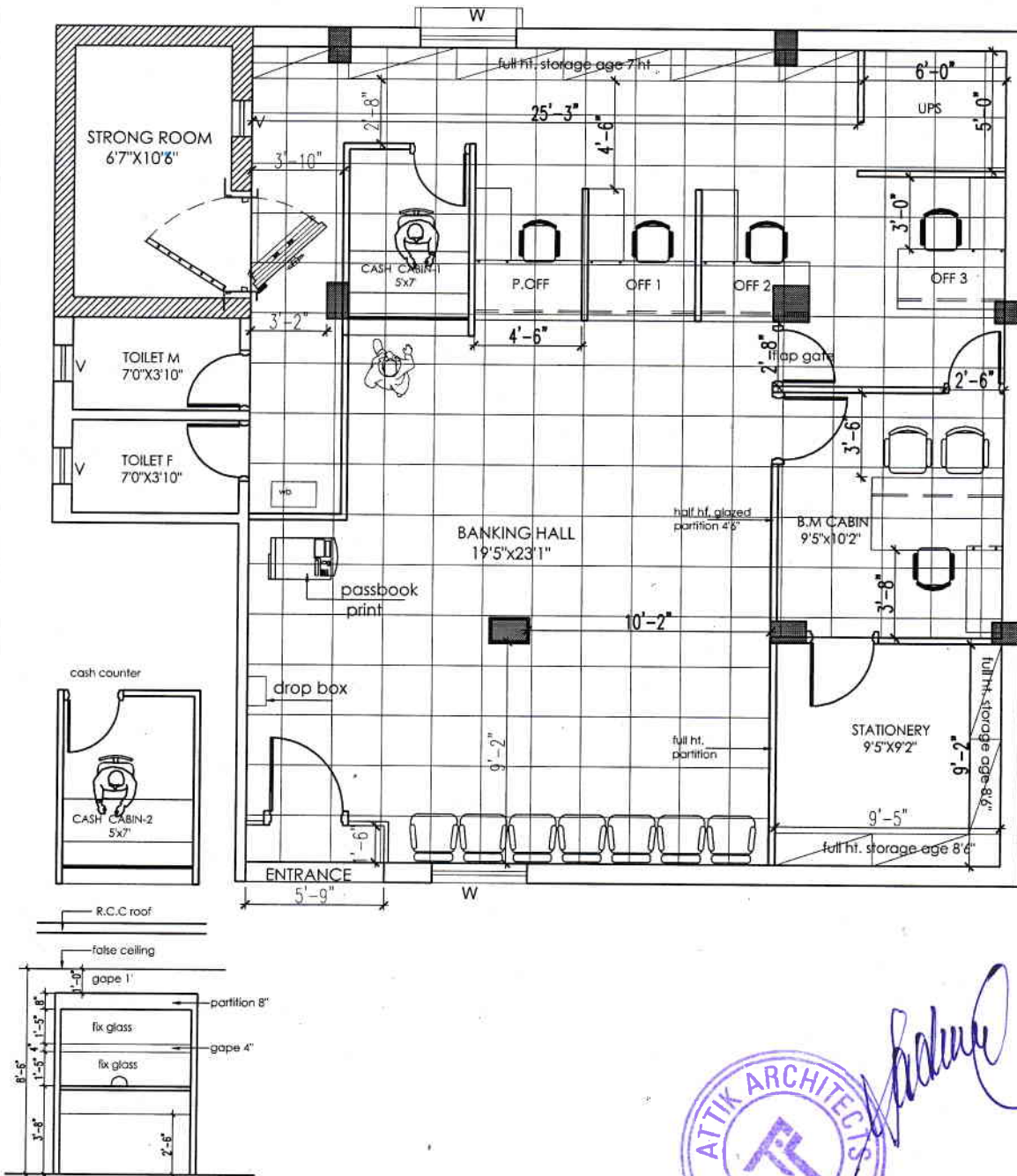

| | | |
|--|---------------------------|--------|
| Date: 21-01-2023 | Checked by: Ar. Sachin | North: |
| Scale: NRS | Drawn by: | |
| DRG. NO:-01 | | R1 |
| <p align="center">ATIK ARCHITECTS</p> <p align="center">This drawing (plan) is property of Atik Architects. No part of it may be reproduced, or implemented in any form without prior permission in writing from Atik Architects. Any person doing so, shall be liable in criminal prosecution and civil suits for damages.</p> | | |



Notes :-

ALL DIMENSIONS ARE TO BE CHECKED AND CORRELATED WITH THE RELEVANT ARCHITECTURAL & STRUCTURAL DRAWINGS AND ANY AMBIGUITY SHALL BE IMMEDIATELY BROUGHT TO THE NOTICE OF THE ARCHITECTS BEFORE COMMENCEMENT OF THE WORK. THIS DRAWING IS THE PROPERTY OF ATTIK ARCHITECTS AND IS NOT TO BE COPIED OR USED WITHOUT THEIR PERMISSION.

Architects :-

ATTIK ARCHITECTS
A T T I K A R C H I T E C T S
100 BUILDING, 10TH FLOOR, NEAR
TAKAMALINI TRAI, BHAGALPUR, JH. INDIA
750002/220
9430546434/939977285

Consultants:-

Drawing Title:-

BRANCH LAYOUT

Client:- **UCO BANK, LODIPUR
BRANCH BHAGALPUR**

REVISIONS

| Sl. No. | Rev. | By | Date |
|---------|------|----|------|
| | | | |
| | | | |
| | | | |

Job title:-

Date:-
21-01-2023

Scale:- HTS

DRG. NO:-01

Checked by:-
Ar. Sachin

Drawn by:-

R1

ATTIK ARCHITECTS

This drawing is the property of Attik Architects. No part of this drawing shall be reproduced or transmitted in any form without prior permission in writing from Attik Architects. Any person doing so shall be liable to criminal prosecution and civil claims for damages.

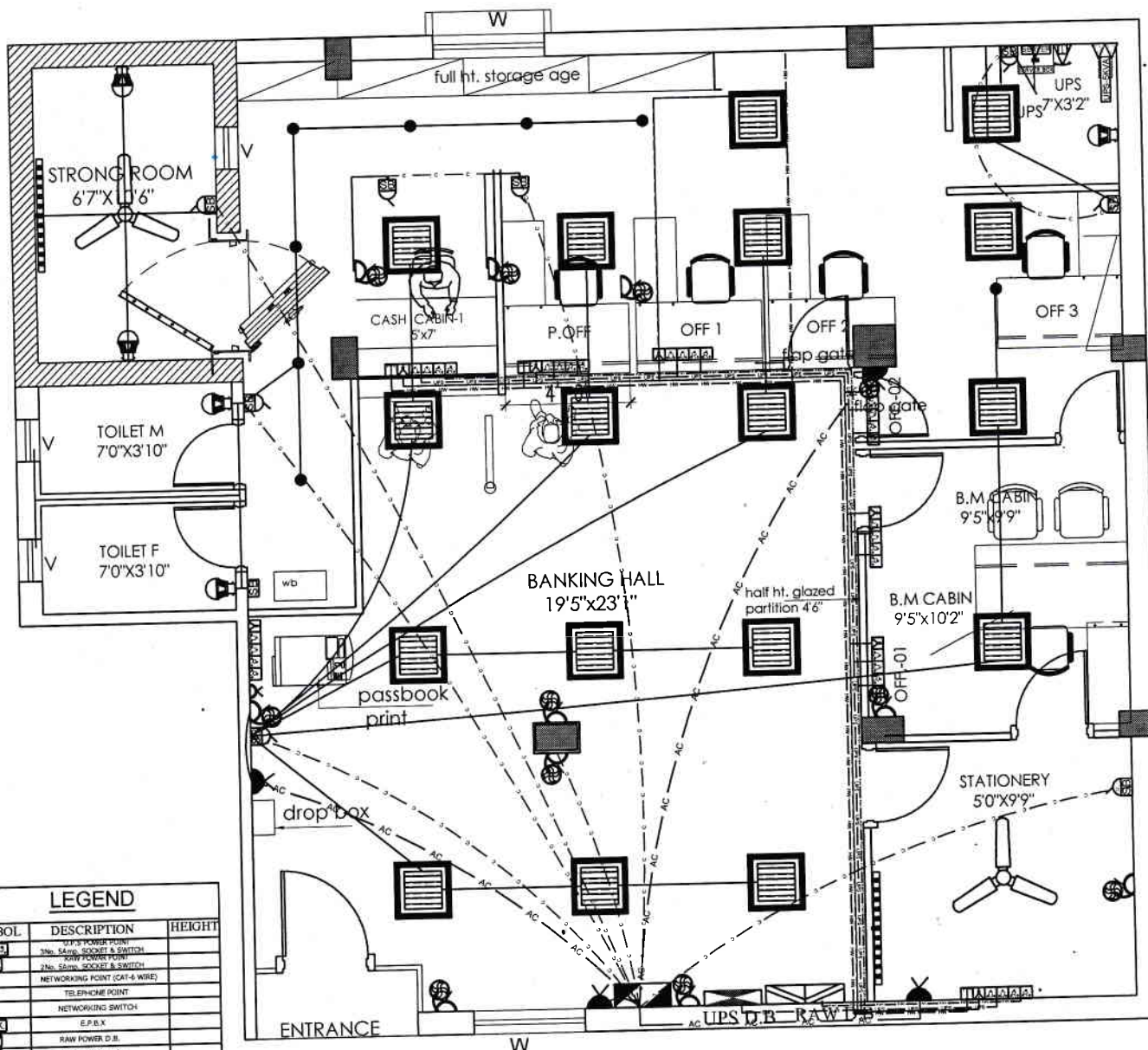

LEGEND

| SYMBOL | DESCRIPTION | HEIGHT |
|--------|--|------------|
| | 220V POWER POINT | |
| | 220V SOCKET & SWITCH | |
| | 220V SOCKET & SWITCH | |
| | 220V SOCKET & SWITCH | |
| | TELEPHONE POINT | |
| | NETWORKING SWITCH | |
| | E.P.B.X. | |
| | RAW POWER D.B. | |
| | U.P.S. POWER D.B. | |
| | U.P.S. PRIMARY & SECONDARY SWITCH & SOCKET | |
| | CEILING FAN | ON CEILING |
| | 40W/40W TUBE LIGHT FITTING | 8'6" |
| | 1X10W / 1X25W C.F.L. | 8'6" |
| | CEILING LIGHT | ON CEILING |
| | SWITCH BOARD WITH SUMP SOCKETS | 4'6" HT |
| | 5 AMPS SWITCH SOCKET | 1'6" HT |
| | 15 AMPS SWITCH SOCKET | 1'6" HT |
| | 2X2 LED LIGHT CEILING | |
| | 25 AMPS SWITCH SOCKET (A.C.) | 1'6" HT |
| | EXHAUST FAN (ON T.C. & H.T.) | |
| | DISTRIBUTION BOARD | |
| | L.T. MAIN CONTROL PANEL | |
| | WALL FAN | 6'6" HT |
| | ROUTE OF UPS POWER WIRING (25MM) | |
| | ROUTE OF RAW POWER WIRING (25MM) | |
| | ROUTE OF NETWORKING WIRING | |
| | ROUTE OF TV WIRING (25MM) | |
| | ROUTE OF POINT WIRING (15MM) | |
| | ROUTE OF POINT WIRING (25MM) | |
| | ROUTE OF CIRCUIT WIRING (25MM) | |
| | ROUTE OF SUB MAIN WIRING (25MM) | |
| | ROUTE OF POWER POINT WIRING (25MM) | |
| | ROUTE OF A.C. POINT WIRING (25MM) | |

Notes :-

ALL DIMENSIONS ARE TO BE CHECKED AND CORRELATED WITH THE RELEVANT ARCHITECTURAL

Architects :-
ATTIK ARCHITECTS
architect
185 BUILDING SITHLA ASTHAN ROAD, NEAR

Drawing Title:-

ELECTRICAL LAYOUT PLAN



| |
|---|
| ROOT OF TELEPHONE WIRING |
| COMPUTER WIRING ROTE |
| UPS POWER WIRING ROTE |
| 2Nos 25mm dia PVC pipe laying in floor/wall/false ceiling for each computer power line. |
| RAW POWER WIRING ROTE |

KRISHNA GOPAL PRASAD (B.E. ELECTRIC)
ELECTRICAL CONSULTANT (EMAIL: kgsprasad63@gmail.com)
(COMPUTER AIDED ELECTRICAL DESIGNER)
H/O. 801 PABE KAMLA A. NERUDA STREET, 4th FLOOR, BHAGALPUR, NEAR: NAGAR
PATILPURA, BHAGALPUR, PATNA (BIHAR) PIN-824001 & 824002

Date:-

13-01-2024

DRAWN BY :-

DHARAMVIR

North:-

CKD. BY :-

K.G. PRASAD

Scale:- NTS

REVISIONS

Rev. No. Date Description

PANEL-1

L.T.PANEL-(SINGAL LINE DIGRAM)

Tr.

3 PH
METER

16Sq.mm.X 4CORE(AL) CABLE
OR. 6Sq.mm.X4 CORE (CU) CABLE
63A HRC FUSE

63Amp 16 K.A T.P.N M.C.C.B

PANEL-2

63Amp 16 K.A T.P.N M.C.C.B

100Amp. COPPER BUS BAR

25 S P N
A N N
Br. A/C. POINT.

63Amp T.P.N
on load change over

100Amp. COPPER BUS BAR

63 AMP
PHASE SLECTOR SWITCH.

LIGHT D.B's

RAW
POWER

16 Sq.mm.X 2 CORE(AL) CABLE
OR 6Sq.mm. x 2CORE (CU) CABLE

PROJECT:-

UCO BANK, LODIPUR
BRANCH BHAGALPUR

KRISHNA GOPAL PRASAD(B.E.ELECTRIC)
(ELECTRICAL CONSULTANT) (EMAIL:-kgprasad62@gmail.com)
(COMPUTER AIDED ELECTRICAL DESIGNER)

402, SUN RISE KAMLA-REKHA SHREE, RAI RAM BRIKSH PATH, NEHRU NAGER
PATLIPUTRA COLONY, PATNA (BIHAR) PIN CODE-800013 PHONE NO -9431066089

UPS PRIMARY & SECONDRY PANEL

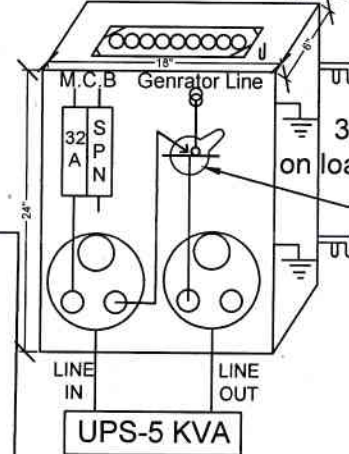

PANEL-3

32Amp D.P.
on load change over

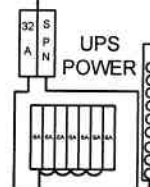

CUPPER PLET EARTH-PIT(HAVEY EARTH PIT)

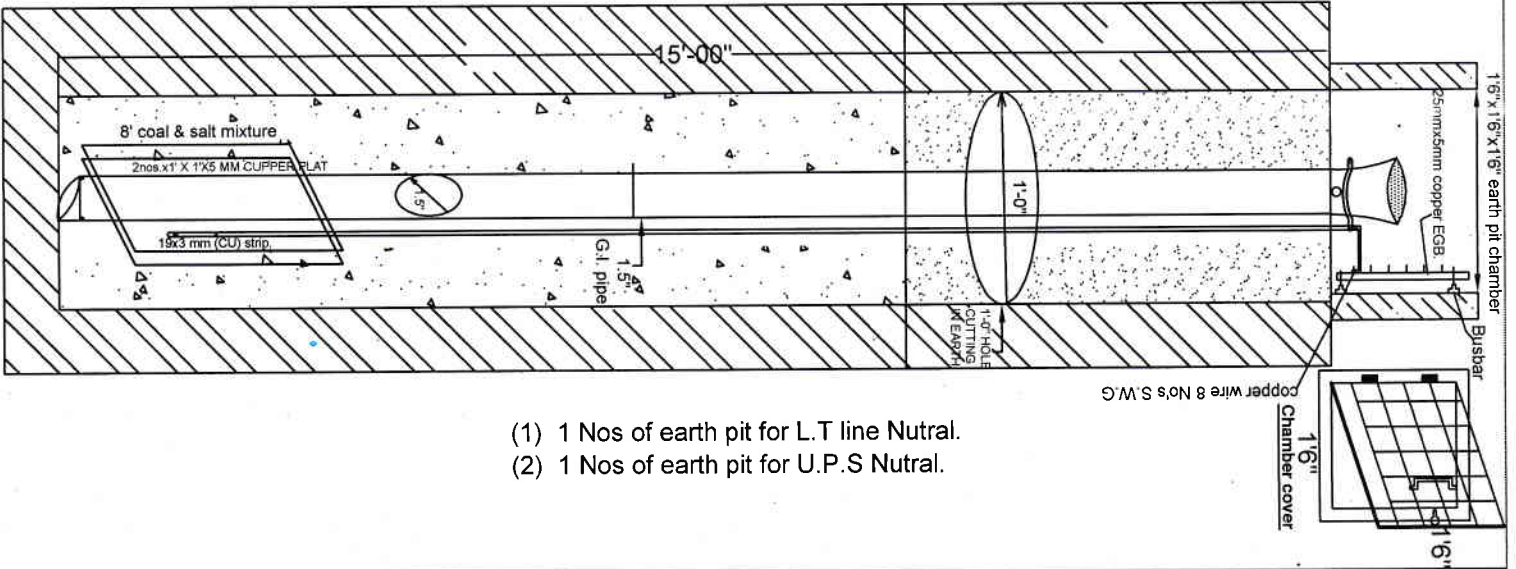

ELECTROD EARTH (LIGHT EARTH)

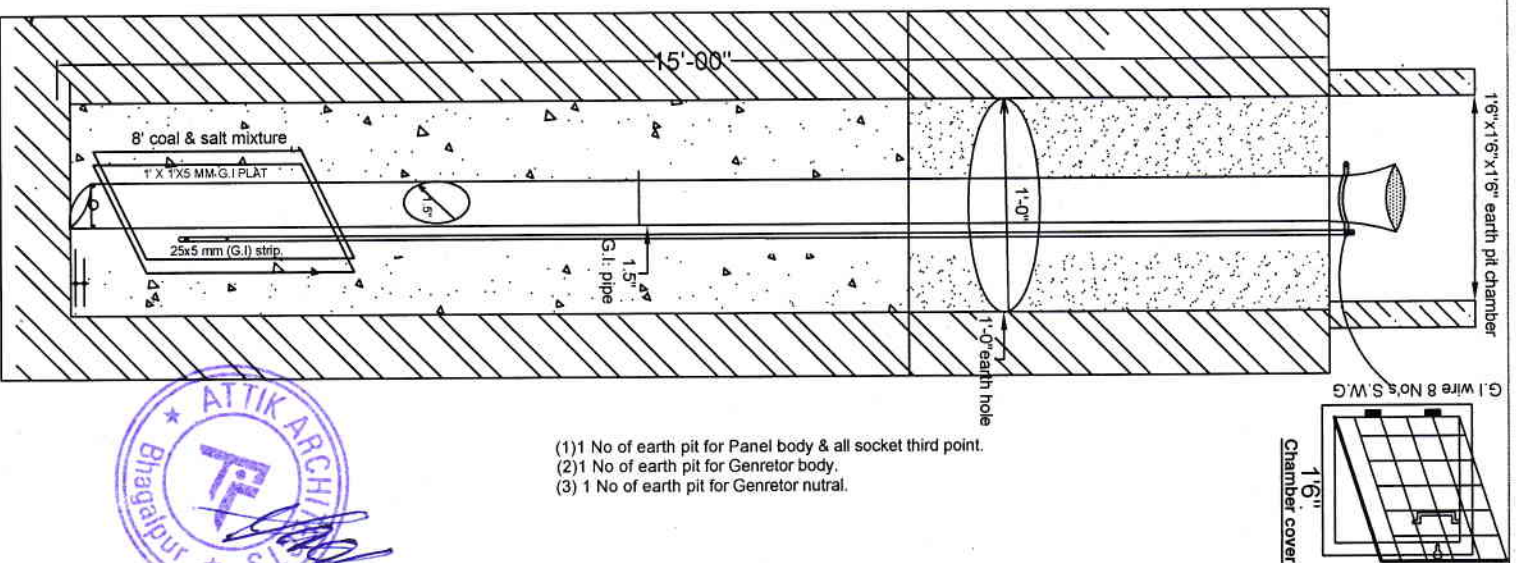

CUPPER PLET EARTH-PIT (HAVEY EARTH PIT)

- 1.-G.I. pipe 15 feet with 8feet net cutting -1 no.
- 2.-G.I. Redution sicket 2.5"/1.5"-1 no.
- 3.-G.I. Plug 2.5" dia-1 no.
- 4.-12"x12" chamber cover-1 no.
- 5.-Copper Plate 24"x12"x3mm-2 no.
- 6.-Copper strip 20mmx3mm-18feet.
- 7.-Salt 10 K.G.
- 8.-Wooden coal- 60 K.G.

G.I PLET EARTH-PIT (LIGHT EARTH PIT)

- 1.-G.I. pipe 15 feet with 8feet net cutting -1 no.
- 2.-G.I. Redution sicket 2.5"/1.5"-1 no.
- 3.-G.I. Plug 2.5" dia-1 no.
- 4.-12"x12" chamber cover-1 no.
- 5.-G.I. Plate 12"x12"x5mm-1 no.
- 6.-Copper wire 6No. SWG-18feet.
- 7.-Salt 10 K.G.
- 8.-Wooden coal- 60 K.G.

1.-The rate shall be inclusive of submission of Test Report- (2 Ohm) of each earth pit and Testing shall be carried out in front of Officials / Consultant.

2.--Earth pit material should be verified by Branch Manager before installation as per specification in B.O.Q..

PROJECT-

UCO BANK, LODIPUR
BRANCH BHAGALPUR



KRISHNA GOPAL PRASAD B.E. (ELECTRIC)
(ELECTRICAL CONSULTANT) (EMAIL:-kprasad62@gmail.com)
(COMPUTER AIDED ELECTRICAL DESIGNER)
402, SUN RISE KAMLA-REKHA SHREE, BAL KAN BRINSHI PATIL, NEHRU NAGAR,
PATILPUTRA COLONY, PATINA (BIHAR) PIN CODE-800013. (PHONE NO. 9431066989)